

Joystick Parts List

1949 Keating Cross Road
 Victoria, B.C. Canada V8M 2A4
 Phone: (250) 544-2207

Fax: (250) 544-2279
 Toll Free: 1-800-831-2278
 www.suregripccontrols.com

SURE GRIP
 CONTROLS INC.

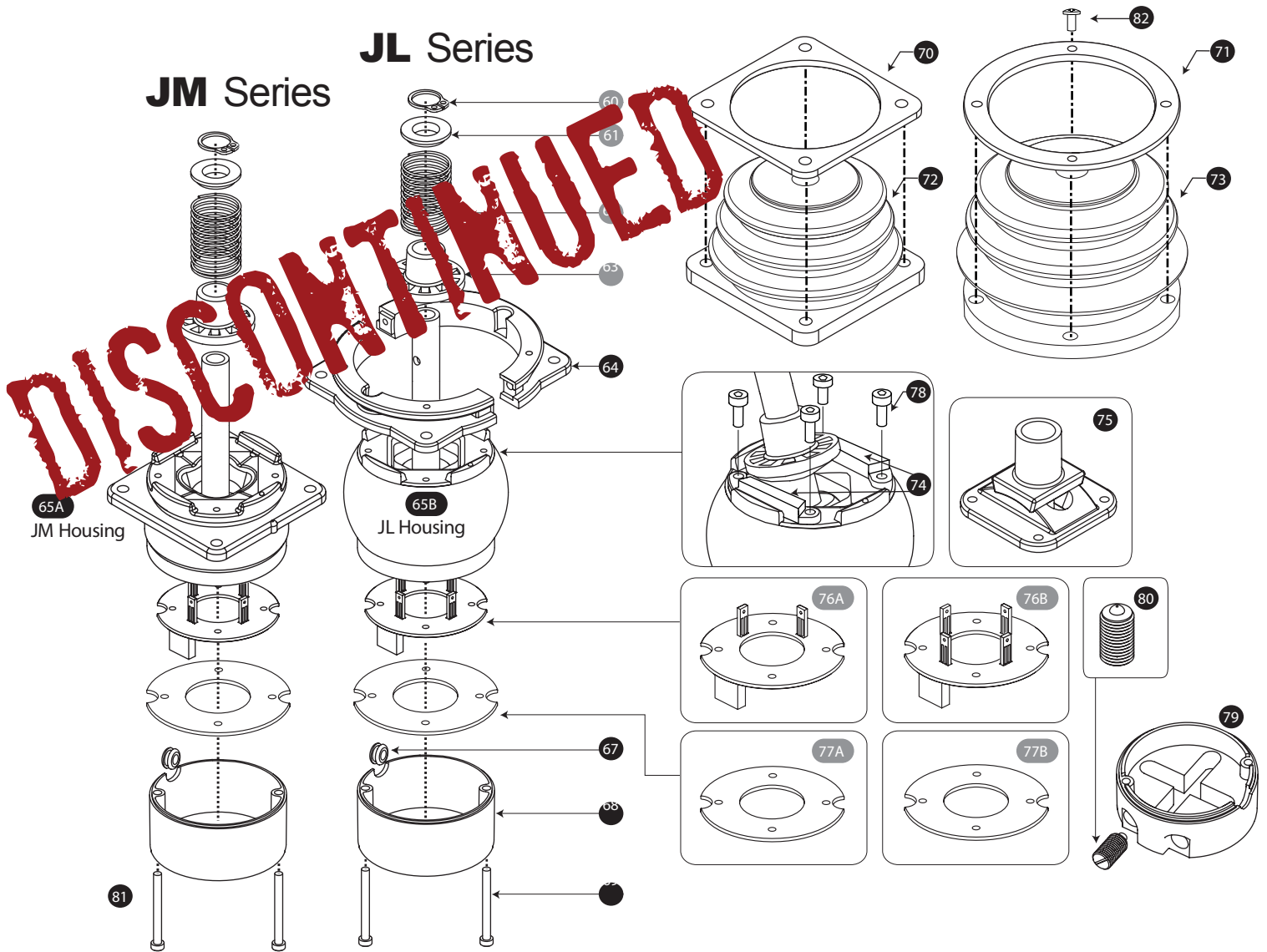

● Serviceable at Factory Only † Used in Assy. Above

| FLG | PART# | DESCRIPTION | FLG | PART# | DESCRIPTION |
|-----|-----------------------------------|--|-----|--------------|--|
| 62 | SP-07Spring:JM/JLJoystick | | 71 | JL-15 | JL Boot Ring |
| 63 | JL-108JM/JLJoystick:CenteringShoe | | 72 | BT-14 | JM Joystick Boot R1 |
| 64 | JL-109-A | JL Joystick: Adjustable Bracket | | SC-50 | † Washer |
| 65A | JM-110 | JM Joystick: 12mm Shaft-Ball Assembly | 73 | BT-15 | JL Joystick Boot R1 |
| | JM-103 | † JM Joystick: Lower Housing (Included in Assy.) | | SC-50 | † Washer |
| | SC-34 | † 6-32 x 3/4" Flat Head Screw, Stainless (Included in Assy.) | 74 | JL-107-A | Joystick: Single Axis Guide Kit |
| | PN-3x16 | † Pin: 3mm x 16mm (Included in Assy.) | 75 | FG-S1 | Joystick Friction Guide Set |
| 68 | JL-102 | † JM Joystick: Housing Cover (Included in Assy.) | 76A | CC-J01-A | JM/JLJoystick:SensorBoard,DualAxis |
| 65B | JL-110 | JL Joystick: 12mm Shaft-Ball Assembly | 76B | CC-J01-X4-A | JM/JLJoystick:SwitchedBoard,DualAxisRedundant |
| | JL-103 | † JL Joystick: Lower Housing (Included in Assy.) | 77A | CC-J-L2-A | JM/JLJoystick:SwitchedBoard,Low current |
| | SC-34 | † 6-32 x 3/4" Flat Head Screw, Stainless (Included in Assy.) | 77B | CC-J-H2-A | JM/JLJoystick:SwitchedBoard,High current |
| | PN-3x16 | † Pin: 3mm x 16mm (Included in Assy.) | 78 | SC-25 | 6-32 x 3/8" Socket Cap Screw, Stainless JL-107-A |
| 68 | JL-102 | † JL Joystick: Housing Cover (Included in Assy.) | 79 | JL-102 Gated | JM/JL Gated Joystick Housing Cover |
| 67 | GR-01 | 3/8" x 1/4" Grommet | 80 | SC-43 | † Spring Plunger: 3/8" x 5/8" High Force |
| 69 | SC-33 | 6-32 x 1.25" Cap Screw, Stainless | 81 | SC-40 | † 6-32 x 1 3/8" Cap Screw, Stainless |
| 70 | JM-14 | JM Boot Ring | 82 | SC-51 | Screw |